

# Image captions



## Image

## File name

## Caption



RichardBrink\_Atrium-2025\_01

With its Atrium shower tray, the company Richard Brink satisfies the highest standards when it comes to creating modern shower areas.

Photo: Richard Brink GmbH & Co. KG

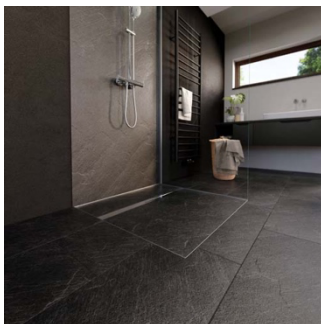

RichardBrink\_Atrium-2025\_02

The integrated system produces a barrier-free shower that lends itself to a variety of styles and finishes thanks to the tile-over shower tray.

Photo: Richard Brink GmbH & Co. KG

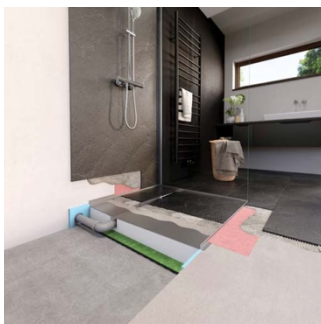

RichardBrink\_Atrium-2025\_03

The product comprises a sound insulation mat, a two-part XPS substructure complete with siphon and a sanded stainless-steel tray with compatible sealing tapes.

Photo: Richard Brink GmbH & Co. KG

# Image captions

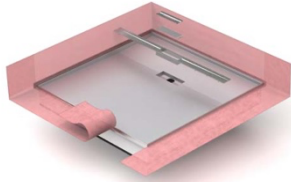

RichardBrink\_Atrium-2025\_04

The shower tray features a prefabricated raised edge along all sides that aids the transition from tray to floor and wall.

Photo: Richard Brink GmbH & Co. KG

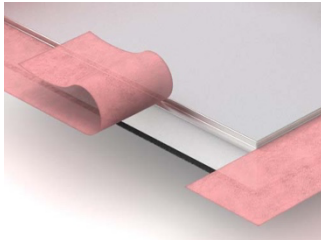

RichardBrink\_Atrium-2025\_05

The sealing tapes form part of the standard scope of delivery and, on request, can be affixed to the tray during production.

Photo: Richard Brink GmbH & Co. KG

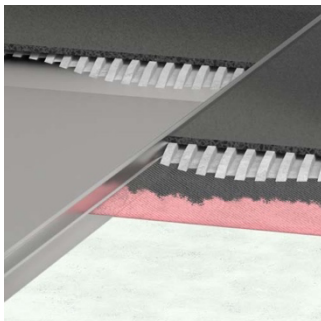

RichardBrink\_Atrium-2025\_06

The system can either be placed into a recess in the screed or positioned on the floor before the screed is laid. The tiles are laid right up to the edge, which makes for a virtually seamless finish.

Photo: Richard Brink GmbH & Co. KG

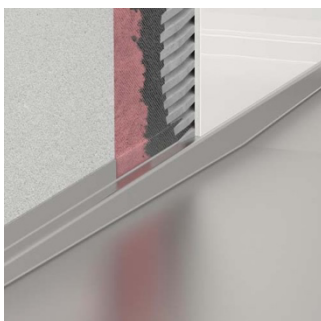

RichardBrink\_Atrium-2025\_07

The transition to the wall areas is also entirely watertight thanks to the tray's surrounding edges and sealing tapes.

Photo: Richard Brink GmbH & Co. KG

# Image captions



RichardBrink\_Atrium-2025\_08

The Atrium's stainless-steel tray always features a gradient, which eliminates the need to create one during installation.

Photo: Richard Brink GmbH & Co. KG

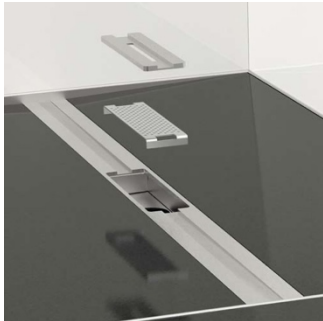

RichardBrink\_Atrium-2025\_09

An insertable draining channel made from polished stainless steel also forms part of the complete package. The channel includes a removable insert complete with hair catcher for easier cleaning.

Photo: Richard Brink GmbH & Co. KG

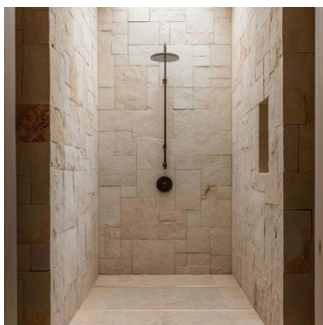

RichardBrink\_Atrium-2025\_10

Regardless of design concept – the Atrium shower tray always caters to the customer's individual preferences while ensuring the highest level of functionality, precision and watertightness.

Photo: Richard Brink GmbH & Co. KG